

OWNER'S STATEMENT

I HEREBY STATE THAT I AM THE OWNER OF OR HAVE SOME RIGHT, TITLE, OR INTEREST IN AND TO THE REAL PROPERTY INCLUDED WITHIN THE SUBDIVISION SHOWN UPON THE HEREIN MAP; THAT I AM THE ONLY PERSON WHOSE CONSENT IS NECESSARY TO PASS CLEAR TITLE TO SAID REAL PROPERTY; AND THAT I CONSENT TO THE PREPARATION AND RECORDATION OF SAID MAP AND SUBDIVISION AS SHOWN WITHIN THE DISTINCTIVE BORDER .

AS OWNER: ROBERT K. ZLATIC

ROBERT K. ZLATIC

OWNER'S ACKNOWLEDGEMENT

A NOTARY PUBLIC OR OTHER OFFICER COMPLETING THIS CERTIFICATE VERIFIES ONLY THE IDENTITY OF THE INDIVIDUAL WHO SIGNED THE DOCUMENT TO WHICH THIS CERTIFICATE IS ATTACHED, AND NOT THE TRUTHFULNESS, ACCURACY, OR VALIDITY OF THAT DOCUMENT.

STATE OF CALIFORNIA)
COUNTY OF SAN MATEO) SS

ON _____ BEFORE ME, _____ PERSONALLY
APPEARED _____ WHO PROVED TO ME ON THE BASIS OF
SATISFACTORY EVIDENCE TO BE THE PERSON(S) WHOSE NAME(S) IS/ARE SUBSCRIBED TO
THE WITHIN INSTRUMENT AND ACKNOWLEDGED TO ME THAT HE/SHE/THEY EXECUTED
THE SAME IN HIS/HER/THEIR AUTHORIZED CAPACITY(IES), AND THAT BY HIS/HER/THEIR
SIGNATURE(S) ON THE INSTRUMENT THE PERSON(S), OR THE ENTITY UPON BEHALF OF
WHICH THE PERSON(S) ACTED, EXECUTED THE INSTRUMENT.

I CERTIFY UNDER PENALTY OF PERJURY UNDER THE LAWS OF THE STATE OF CALIFORNIA
THAT THE FOREGOING PARAGRAPH IS TRUE AND CORRECT.

WITNESS MY HAND

SIGNATURE NOTARY: _____

NAME (PRINTED OR TYPED): _____

MY COMMISSION EXPIRES: _____

COUNTY OF NOTARY: _____

CITY ENGINEER'S STATEMENT

I HAVE EXAMINED THE MAP. THE SUBDIVISION AS SHOWN IS SUBSTANTIALLY
THE SAME AS IT APPEARED ON THE TENTATIVE MAP, AND ANY APPROVED
ALTERATIONS OF THE TENTATIVE MAP, IF ANY. ALL PROVISIONS OF THE
SUBDIVISION MAP ACT AND ANY LOCAL ORDINANCES APPLICABLE AT THE TIME
OF APPROVAL OF THE TENTATIVE MAP HAVE BEEN COMPLIED WITH.

DATE

BRAD B. UNDERWOOD, DIRECTOR OF PUBLIC WORKS
REGISTRATION NO.: 43093

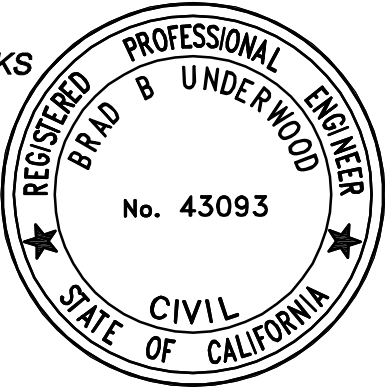

CITY SURVEYOR'S STATEMENT

I AM SATISFIED THAT THIS MAP IS TECHNICALLY CORRECT.

DATE

BRAD B. UNDERWOOD, CITY SURVEYOR
LS NO. 7670

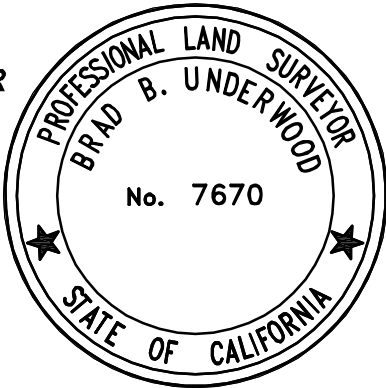

PARCEL MAP NO. 471
1 LOT SUBDIVISION FOR CONDOMINIUM
PURPOSES
(2 RESIDENTIAL UNITS)

BEING ALL OF LOT 17, AS SHOWN ON THE MAP ENTITLED
"MAP OF BAYSHORE HIGHWAY TRACT", FILED IN BOOK 14 OF
MAPS AT PAGES 42-43, SAN MATEO COUNTY RECORDS

CITY OF SAN MATEO
SAN MATEO COUNTY, CALIFORNIA



817 Arnold Drive, Ste. 50
Martinez, CA 94553
Ph: (925) 476-8499
www.apexce.net

OCTOBER, 2020

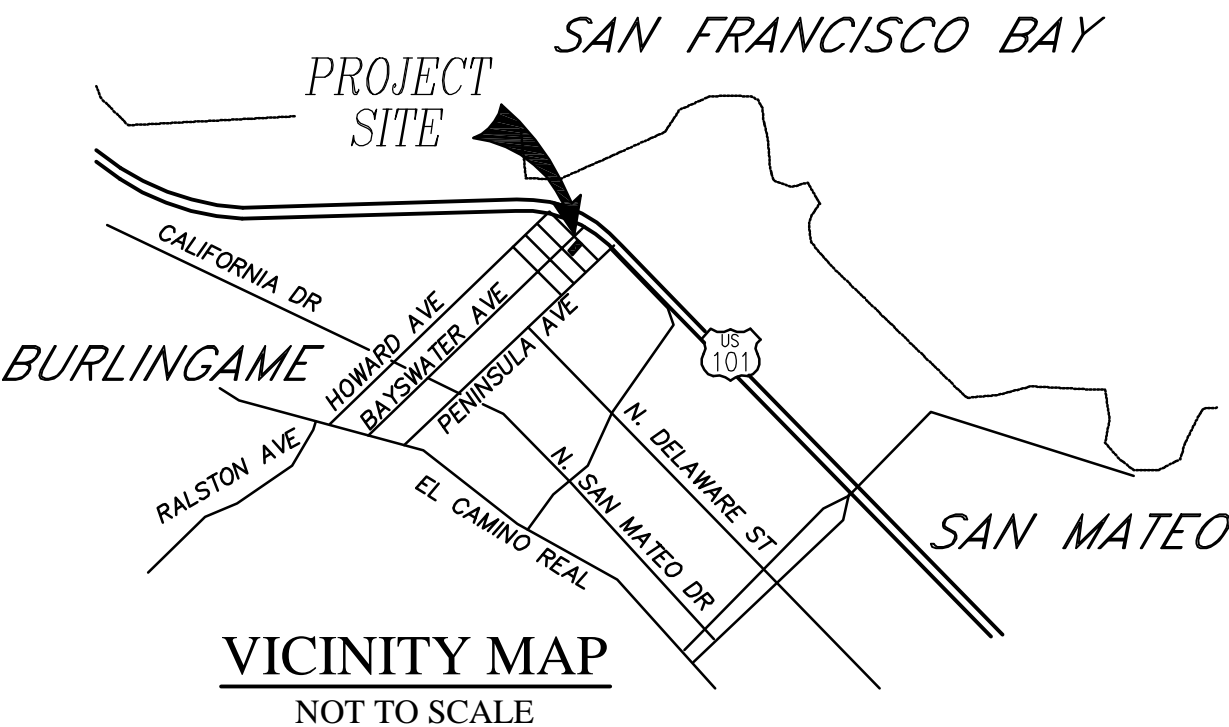

VICINITY MAP
NOT TO SCALE

SURVEYOR'S STATEMENT

THIS MAP WAS PREPARED BY ME OR UNDER MY DIRECTION
AND IS BASED UPON A FIELD SURVEY IN CONFORMANCE WITH
THE REQUIREMENTS OF THE SUBDIVISION MAP ACT AND LOCAL
ORDINANCE AT THE REQUEST OF ROBERT ZLATIC IN MARCH
OF 2017. I HEREBY STATE THAT ALL THE MONUMENTS ARE OF
THE CHARACTER AND OCCUPY THE POSITIONS INDICATED OR
WILL BE SET IN SUCH POSITIONS ON OR BEFORE DECEMBER,
2020, AND ARE OR WILL BE SUFFICIENT TO ENABLE THE
SURVEY TO BE RETRACED, AND THAT THIS PARCEL MAP
SUBSTANTIALLY CONFORMS TO THE CONDITIONALLY APPROVED
TENTATIVE MAP.

DATED: _____

BOB J. LEZCANO L.S. 8514

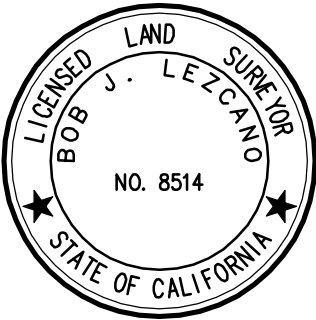

CITY CLERK'S STATEMENT

I, PATRICE M. OLDS, CITY CLERK OF THE CITY OF SAN MATEO, HEREBY CERTIFY THAT
THE CITY COUNCIL OF SAID CITY AT ITS REGULAR MEETING HELD ON _____, DULY
APPROVED THE MAP SHOWN HEREON AND AUTHORIZED ITS RECORDATION.

DATE

PATRICE M. OLDS, CITY CLERK

COUNTY RECORDER'S STATEMENT

FILED THIS ___ DAY OF _____, 20___, AT A.M./P.M. IN BOOK ___ OF
_____, AT PAGE(S) ___, AT THE REQUEST OF PATRICE M. OLDS, CITY CLERK OF
THE CITY OF SAN MATEO.

FILE NO.

DEPUTY RECORDER
MARK CHURCH, SAN MATEO COUNTY RECORDER

FEE

